

MÁQUINA LIMPIADORA DE PIEZAS

REF. 1000350001



CAUTION

Read, understand, & follow all instructions and safety warnings before using this Parts Washer. Failure to follow instructions & safety warnings may result in personal injury and/or property damage.

SPECIFICATIONS

Overall Dimensions	30-3/4"x21-3/4"x35-3/4"
Tank Dimensions	29-7/8"x20-3/4"x10-3/4"
Max Solvent Capacity	20 Gallons
Max Pump Output	20L/Min
Gross Weight	28 Kgs

OPERATION NOTE:

1. Remove parts washer from carton and inspect for any damage.
2. Remove parts inside the machine.
3. Lay clean and hard cardboard on the floor and lay machine on its lid.
4. Mount four legs on tank with M6x12 screws, M6 Nuts and Lock Washers M6. NOTE: DO NOT TIGHTEN.
5. Place lower shelf between legs with flat surface up and attach to legs with M6x12 screws, M6 nuts and M6 Lock Washers.
6. With legs press tight against lower shelf, tighten all screws to lower shelf.
7. Tighten all the screws installed in step 4.
8. Stand machine up, be careful to hold lid closed.
9. Put work shelf and basket into the machine.
10. Mount pump assembly into slot on the side of the machine then place filter screen in position.
11. Plug machine into standard 220V/60Hz grounded outlet and fill with proper amount of fluid.
12. Make sure the liquid level will not exceed the work shelf.
13. Turn switch on. Fluid should now be flowing from the flexible spigot.
14. If the liquid couldn't come out from the flexible spigot, please turn off the switch first, using the accessories injector aim at the mouth of the pipe, push the injector to clean

out the air in the pump. Then turn on the switch again.

IMPORTANT SAFETY INSTRUCTIONS

1. Read all instructions before operating.
2. Keep work area clean. Cluttered areas invite injuries.
3. Keep Children Away. All children should be kept away from the work area. Don't let them handle tool.
4. Do not operate the parts washer if under the influence of alcohol or drugs. Read warning labels on prescriptions to determine if your judgment or reflexes are impaired while taking drugs. If there is any doubt, do not attempt to operate.
5. Read all information concerning the solvent you are using. Do not use solvents with a flashpoint of less than 150 centigrade. Biodegradable solvents are recommended as the use of mineral solvents or petroleum based solvents will cause premature pump wear. Chlorinated solvents, e.g. 1-1-1 Dichloromethane and Methylene Chloride (also known as methyl chloride) can chemically react with aluminum and may explode so are strictly prohibited as this tool contains aluminum. If you are in any doubt whatsoever, contact the solvent manufacturer.
6. Care must be taken as burns can occur from touching hot parts.
7. Do not operate equipment with a damaged cord or if the equipment has been dropped or damaged-until it has been examined by a qualified serviceman.
8. Do not let cord hang over edge of table, bench or counter or come in contact with hot manifolds or moving fan blades.
9. If an extension cord is necessary, a cord with a current rating equal to or more than that of the equipment should be used. Cords rated for less current than the equipment may overheat. Care should be taken to arrange the cord so that it will not be tripped over or pulled.
10. Always unplug equipment from electrical outlet when not in use. Never use the cord to pull the plug from the outlet. Grasp plug and pull to disconnect.
11. Let equipment cool completely before putting away. Loop cord loosely around equipment when storing.
12. To reduce the risk of fire, do not operate equipment in the vicinity of open containers of flammable liquids (gasoline).
13. Adequate ventilation should be provided when working on operating internal combustion engines.
14. Keep hair, loose clothing, fingers, and all parts of body away from moving parts.
15. To reduce the risk of electric shock, do not use on wet surfaces or expose to rain.
16. Use only as described in this manual. Use only manufacturer's recommended attachments.
17. ALWAYS WEAR SAFETY GLASSES. Everyday eyeglasses only have impact resistant lenses, they are NOT safety glasses.

SAVE THESE INSTRUCTIONS

WARNING: Do not fill parts washer above the top level water level mark.

PARTS DRAWING

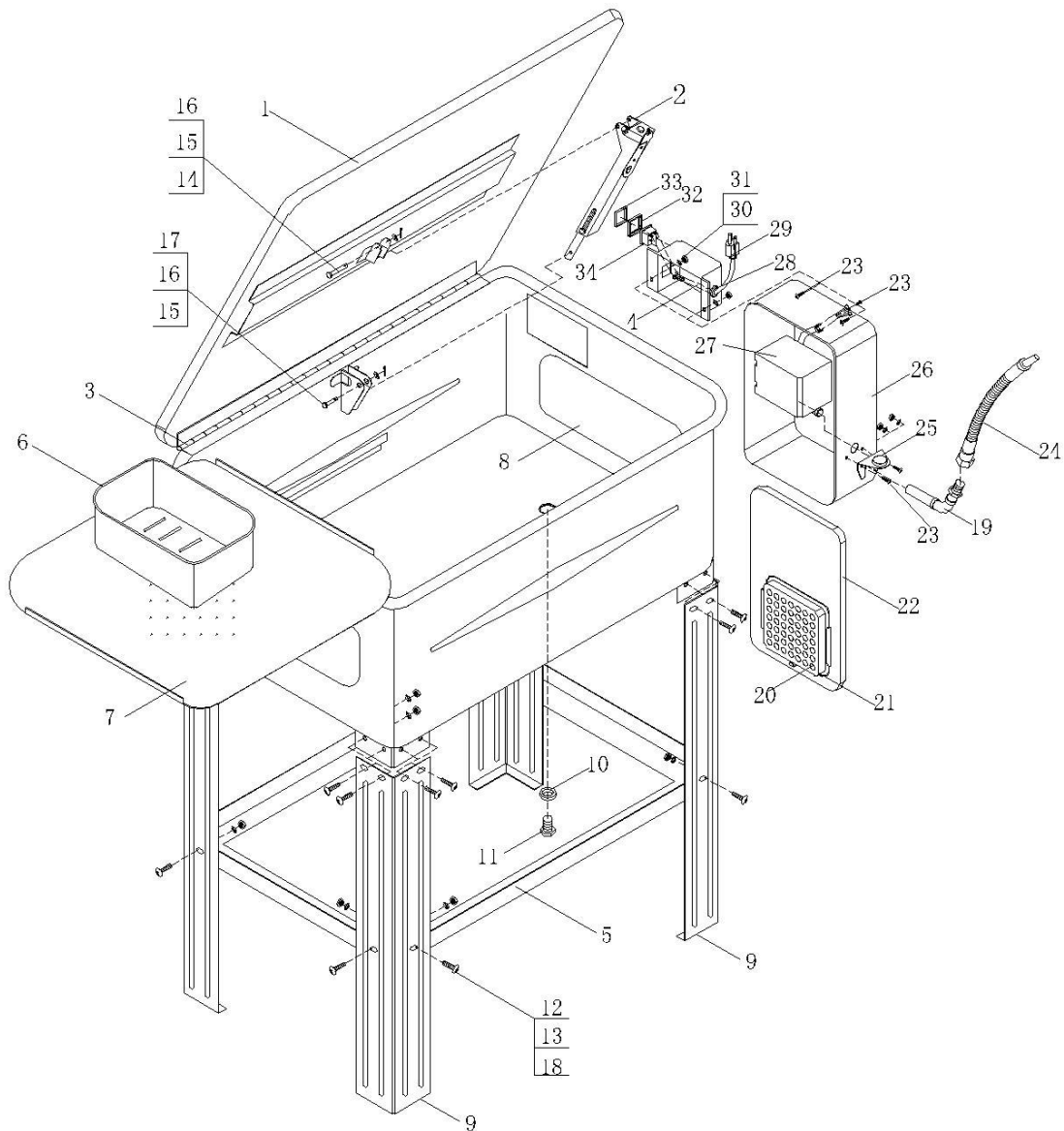

No	Description	QTY	No	Description	QTY	No	Description	QTY
1	Cover	1	13	Nut M6	24	25	Pipe Bracket	1
2	Support	1	14	Pin Ø5x30	1	26	Tank Assembly	1
3	Hinge	1	15	Flat Washer Ø5	2	27	Pump	1
4	Switch Box	1	16	Split Pin Ø1.5x12	2	28	Seal Ring	2
5	Lower Shelf	1	17	Pin Ø5x20	1	29	Wire Socket	1
6	Washer Tank	1	18	Lock Washer Ø6	24	30	Lock Washer Ø4	5
7	Shelf	1	19	Pipe Adaptor	1	31	Nut M4	5
8	Main Tank	1	20	Filter	1	32	Switch Cover	1
9	Leg	4	21	Filter Lid	1	33	Waterproof Switch Cover	1
10	O Ring	1	22	Tank Lid	1	34	Switch Base	1
11	Oil Plug	1	23	Screw M4x10	5			
12	Screw M6x12	24	24	Flexible Pipe	1			